



Model: _____ Item #: _____ Date: _____

Project: _____ Qty: _____ Approved By: _____

Combination Ice Bins with 12" Bottle Storage

Royal Series Underbar



KR19-M36L-10
shown with optional
Wire Racks (KR-421)



Standard Features

- 12" deep ice bin with 1" drain, 1/2" drain with cold plate
- Insulated 12" bin section for wire racks or bottle wells with 1" drain
- Soda line access cutout in rear on cold plate units
- Optional 15" deep liner that holds 25% more ice (KR-502)
- Optional built-in speed rail
- 10-Circuit cold plate available
- Ice bins with cold plates include 1/2" x 6" PVC tailpiece (1/2" - 20 male threaded)
- Ships as a complete station

Specifications

- Interior: 20 gauge stainless steel.
- 12" deep ice bin section, 10" deep bottle section
- Front apron: 20 gauge stainless steel clad over 20 gauge galvanized steel
- Sides: 20 gauge stainless steel
- Backsplash: 20 gauge stainless steel
- Back & Bottom: 20 gauge galvanized steel

Materials

- 1" NPS drain, bottle section
- 1" IPS drain, ice bin

Drains & Plumbing

- 1/2" IPS drain, ice bin with cold plate
- Ice bin with cold plate includes 1/2" x 6" PVC tailpiece (1/2" - 20 threaded). PVC tailpiece required to avoid condensation through metal to metal contact.

Cold Plate

- Cast aluminum post mix plate with 10 circuits. Plate is sealed into bottom. Each circuit is 5/16" OD stainless steel tubing. Two full with remainder to be half circuits. Bump and swedge fittings on ends.

Tubing Access (Cold Plate)

- 3/4" x 3-1/2" cutout in left side of backsplash

Insulation

- Foamed-in-place polyurethane

Backsplash

- 6-1/2"H x 1-1/2"D

Legs

- 1-5/8" tubular legs w/ grey plastic bullet foot

Optional Speed Rails



RS-24

RD-24

Single Speed Rails

Model	Length
RS-36	36"
RS-42	42"
RS-48	48"

Double Speed Rails

Model	Length
RD-36	36"
RD-42	42"
RD-48	48"

Options & Accessories

Model	Description
KR-103	12" Deep Stainless Steel Divider for 19"D Ice Bins (KR19)
KR-109	12" Deep Stainless Steel Divider for 19"D Ice Bins (KR19)
KR-113	15" Deep Stainless Steel Divider for 24"D Ice Bins (KR24)
KR-114	15" Deep Stainless Steel Divider for 24"D Ice Bins (KR24)
KR-303	Left & Right End Side Splashes for 19"D Ice Bins (KR19)
KR-310	Right End Side Splash for 19"D Ice Bins (KR19)
KR-311	Left End Side Splash for 19"D Ice Bins (KR19)
KR-313	Left & Right End Side Splashes for 24"D Ice Bins (KR24)
KR-314	Right End Side Splash for 24"D Ice Bins (KR24)
KR-315	Left End Side Splash for 24"D Ice Bins (KR24)

Model	Description
KR-401	Cap Catcher and Opener
KR-406	Faucet Installed Over Ice Bin
KR-421	2 Metal Wire Racks
KR-501	Towel Ring
KR-502	15" Deep Liner on Ice Station
SC"XX"H	Partial Sliding Cover Ice Bin ("XX" denotes size of Ice Bin. Example: SC24H)
SC"XX"F	Full Sliding Cover Ice Bin ("XX" denotes size of Ice Bin. Example: SC24F)



Cold Plate Units supplied with 1/2" x 6" PVC tailpiece (1/2" - 20 male threaded)
Model: KR-CPN6



Model: _____ Item #: _____ Date: _____

Project: _____ Qty: _____ Approved By: _____

Combination Ice Bins with 12" Bottle Storage

Royal Series Underbar

Top View

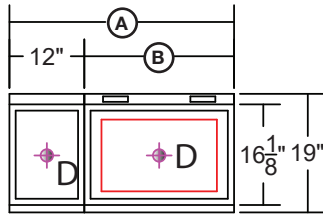

Front View

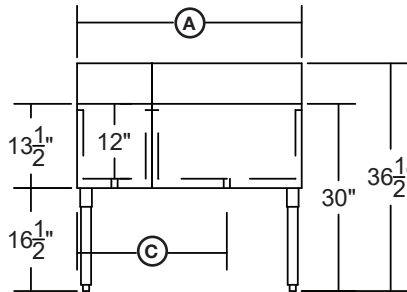

Front View - Cold plate models

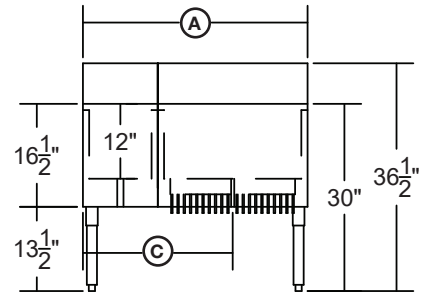

19" Depth

							Cold Plate Models			
Overall Length	Depth	Ice Bin Length	Ice Bin Location	Left Side to Ice Bin Drain	Ice Capacity	Bottles Stored	Model	Wgt. (lbs.)	Models with Cold Plate	Wgt. (lbs.)
(A)		(B)		(C)						
36"	19"	24"	Right	24"	74	6	KR19-M36R	95	KR19-M36R-10	172
36"	19"	24"	Left	12"	74	6	KR19-M36L	95	KR19-M36L-10	172
42"	19"	30"	Right	27"	92	6	KR19-M42R	108	KR19-M42R-10	185
42"	19"	30"	Left	15"	92	6	KR19-M42L	108	KR19-M42L-10	185
48"	19"	36"	Right	30"	110	6	KR19-M48R	116	KR19-M48R-10	193
48"	19"	36"	Left	18"	110	6	KR19-M48L	116	KR19-M48L-10	193
48"	19"	24"	Center	24"	74	12	KR19-M48C	116	KR19-M48C-10	193

Top View

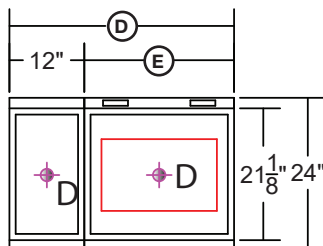

Front View

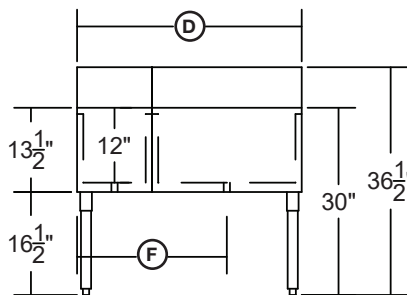

Front View - Cold plate models

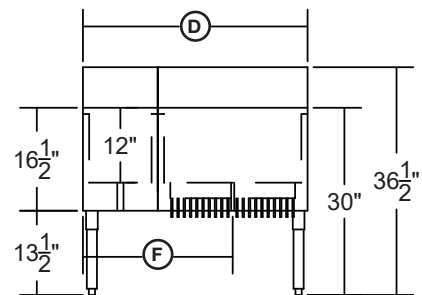

24" Depth

							Cold Plate Models			
Overall Length	Depth	Ice Bin Length	Ice Bin Location	Left Side to Ice Bin Drain	Ice Capacity	Bottles Stored	Model	Wgt. (lbs.)	Models with Cold Plate	Wgt. (lbs.)
(D)		(E)		(F)						
36"	24"	24"	Right	24"	92	8	KR24-M36R	108	KR24-M36R-10	185
36"	24"	24"	Left	12"	92	8	KR24-M36L	108	KR24-M36L-10	185
42"	24"	30"	Right	27"	115	8	KR24-M42R	121	KR24-M42R-10	198
42"	24"	30"	Left	15"	115	8	KR24-M42L	121	KR24-M42L-10	198
48"	24"	36"	Right	30"	138	8	KR24-M48R	129	KR24-M48R-10	206
48"	24"	36"	Left	18"	138	8	KR24-M48L	129	KR24-M48L-10	206
48"	24"	24"	Center	24"	92	16	KR24-M48C	129	KR24-M48C-10	206